

We believe in the power of education to elevate the human condition—to create innovators and leaders who can resolve the challenges of the 21<sup>st</sup> century. We believe in the power of great design to shape the educational experience and inspire human success.



# WEST TEXAS A&M UNIVERSITY

## CAMPUS MASTER PLAN UPDATE: ADVISORY GROUP SESSION

SEPTEMBER 6<sup>TH</sup>, 2017

## **ADVISORY COMMITTEE MEETING AGENDA**

**Introductions + Organization**

**Group Organization**

**How to Master Plan**

**Discussion**



SERVED OVER 250 HIGHER EDUCATION  
INSTITUTIONS NATION-WIDE

COMPLETED 142 CAMPUS MASTER PLANS

**WE BELIEVE IN THE  
STRENGTH OF IDEAS  
AND THE POWER OF  
RELATIONSHIPS**

# YOUR TEAM

## TEAM MEMBERS



**STEPHEN COULSTON**

Planning Principal  
Perkins+Will



**ANDREW BRODERICK**

Senior Planner / Programmer  
Perkins+Will



**PAUL WARD**

Project Planner  
Perkins+Will



**PETER BAIRD**

Senior Planner  
Perkins+Will



**CAITLIN ADMIRE**

Senior Planner  
Perkins+Will



**BENJAMIN SPORER**

Sr. Landscape Architect  
Perkins+Will



**JASON SCHRIEBER**

Transportation  
Nelson Nygaard

# YOUR TEAM

## TEAM MEMBERS





# WHY MASTER PLAN?



## TECH SAVVY + HIGHLY INTERACTIVE

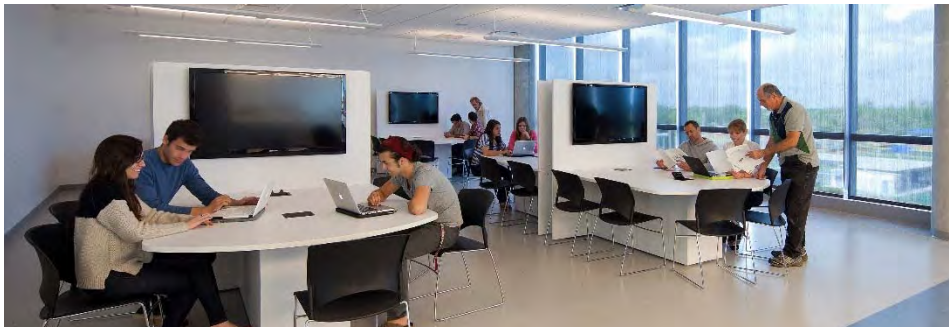

## BRAND IMPORTANCE

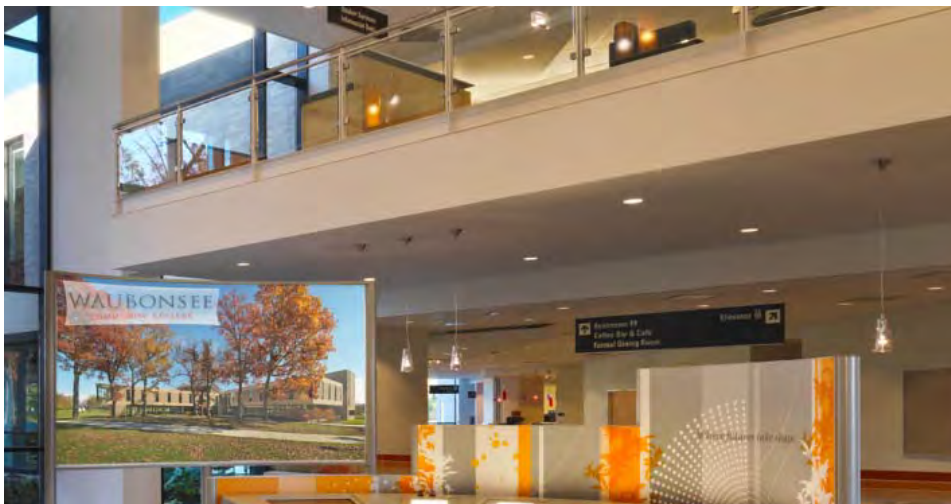
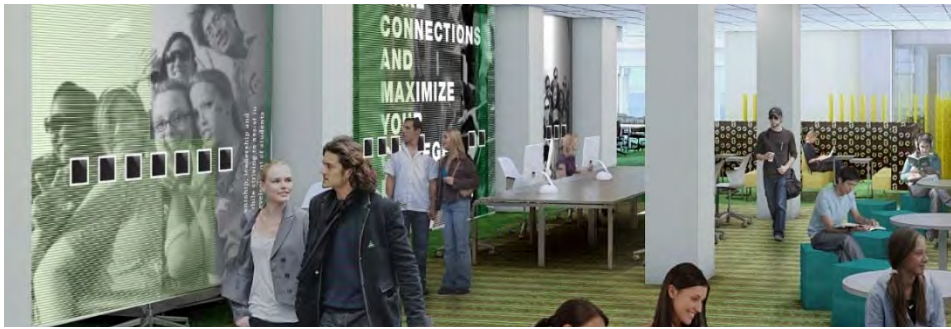

SOPHISTICATED + PRICE CONSCIOUS CONSUMERS



**STUDENT FOCUSED**

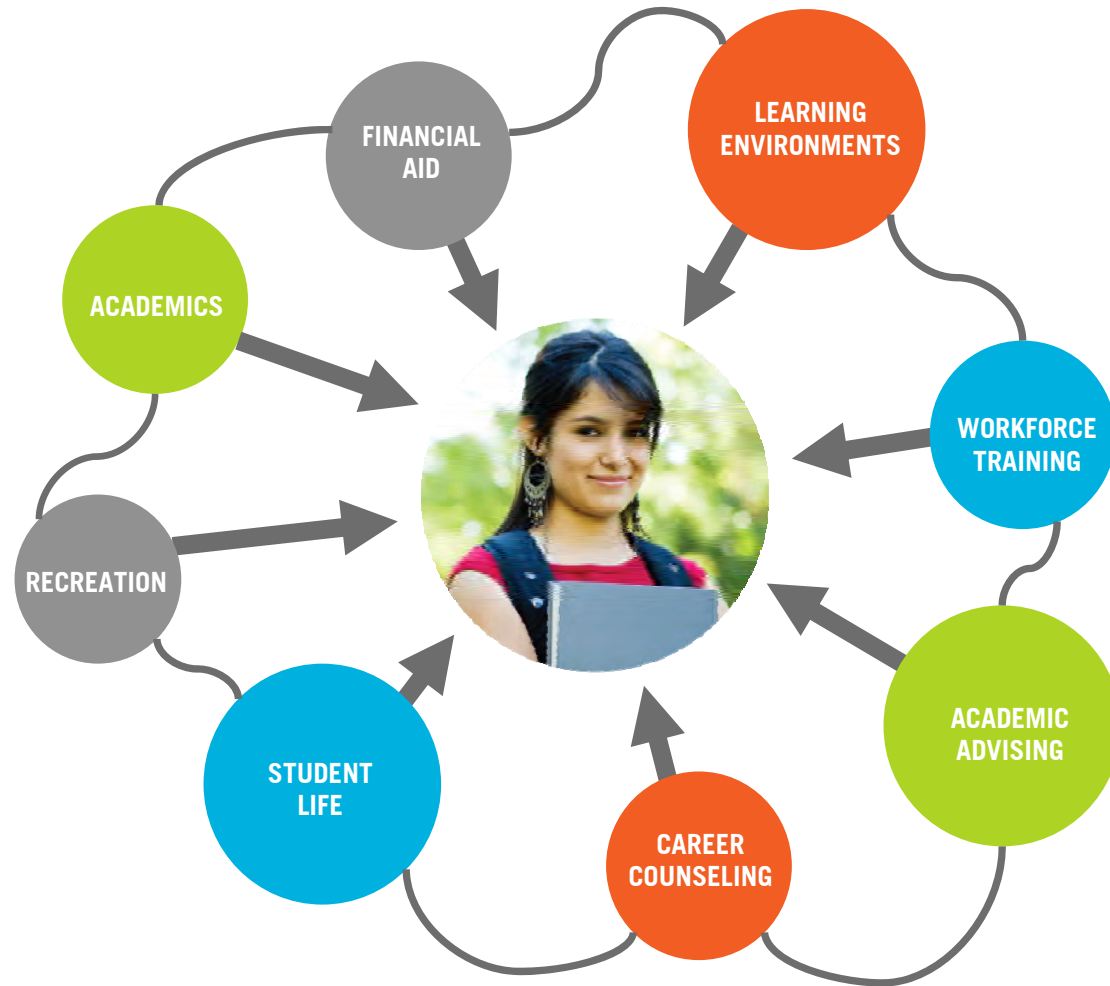

## WHY MASTER PLAN?



THINK BIG AND  
EXPLORE IDEAS

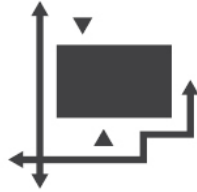

IMPROVE EFFICIENCIES  
AND ENSURE THAT PROPER  
INFRASTRUCTURE IS IN PLACE



CREATE A SENSE OF PLACE  
AND WEAVE CONNECTIONS BACK  
TO THE COMMUNITY



IDENTIFY NEEDS, DEVELOP  
COST-EFFECTIVE SOLUTIONS,  
AND PRIORITIZE INVESTMENT



ALIGNMENT WITH  
STRATEGIC GOALS OF  
THE INSTITUTION



# HOW TO MASTER PLAN (THE PROCESS)

## CONSENSUS BUILDING

**“I’m against anything I’m not in on.”**

*- Carl Coulston*

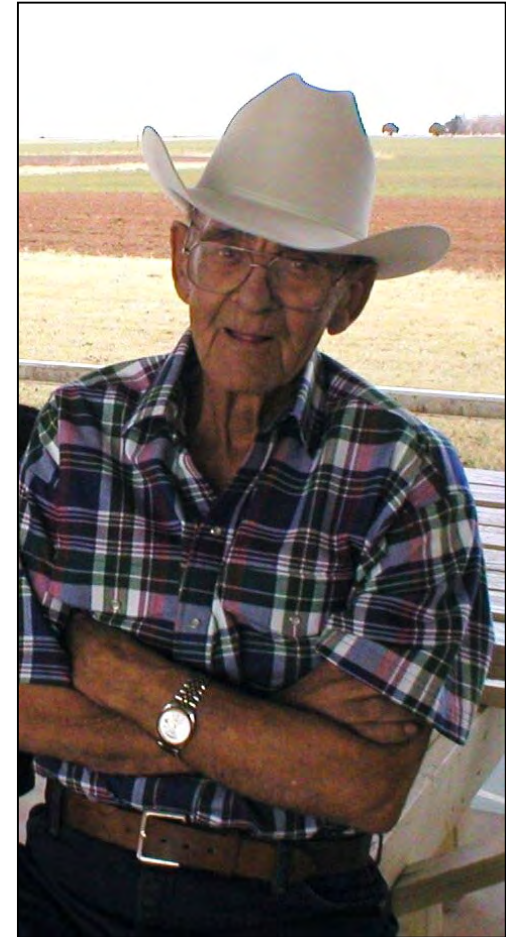

# ENGAGEMENT TOOLBOX

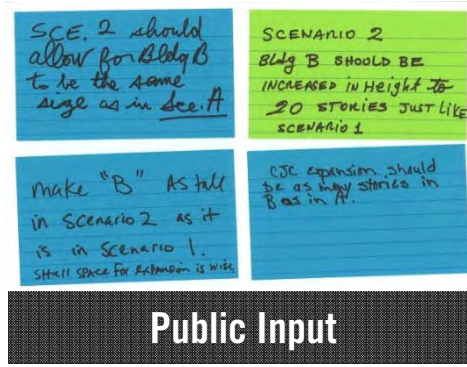



## PROJECT PROCESS



- Existing information/data gathering
- Form committee and stakeholder groups
- Master Plan listening sessions and tours
- Identify project goals and vision
- Agree schedule for project delivery

## PROJECT PROCESS

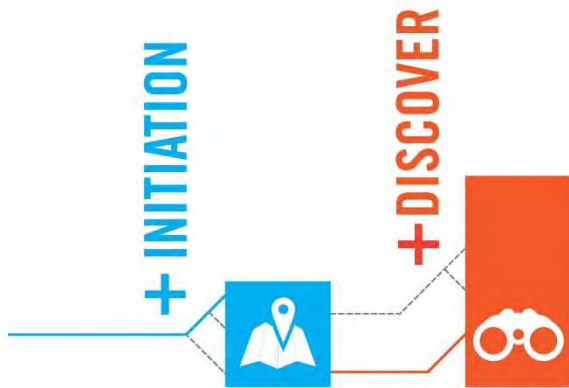

- Existing physical conditions analysis
- Existing facilities documentation
- Task Force and stakeholder interviews
- Assess existing and proposed academic program
- Create space and program needs analysis

## PROJECT PROCESS

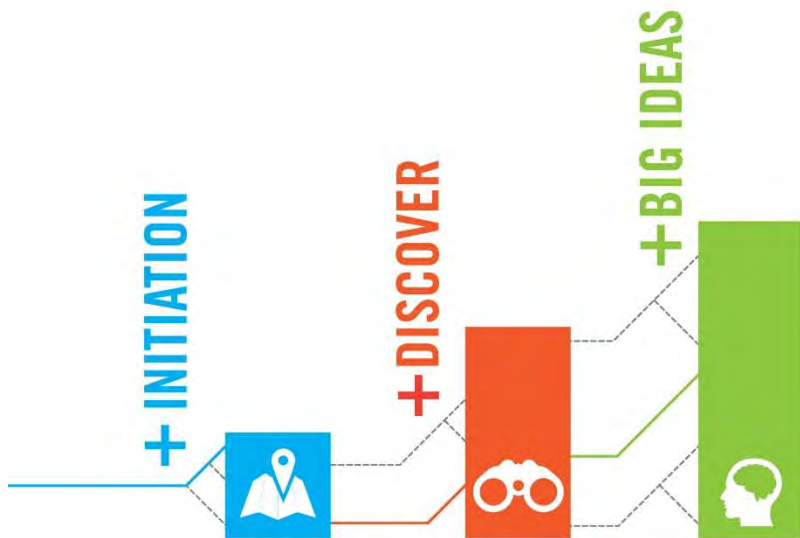

- Development of planning scenarios
- Generate big picture ideas
- Create key principles based on vision and goals
- Prepare preliminary space projections

## PROJECT PROCESS

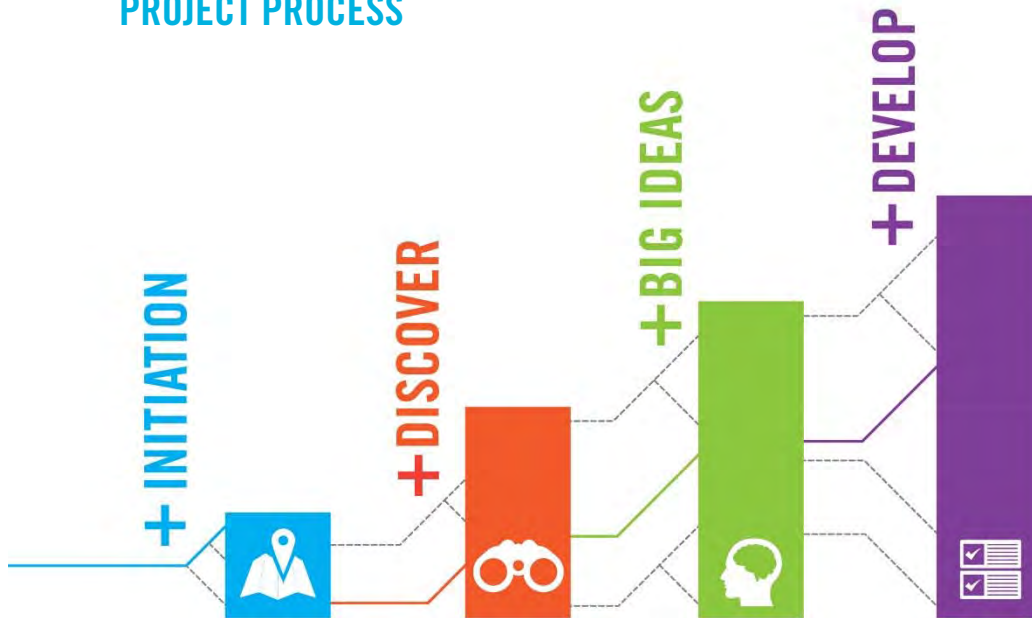

- Advance concept plan with greater level of detail
- Ensure alignment of program and concept
- Locate new facilities if necessary and evaluate the re-use of existing facilities
- Illustrate ideas through detailed drawings, construct detailed quantitative visuals
- Evaluate cost effectiveness and estimate construction costs

## PROJECT PROCESS

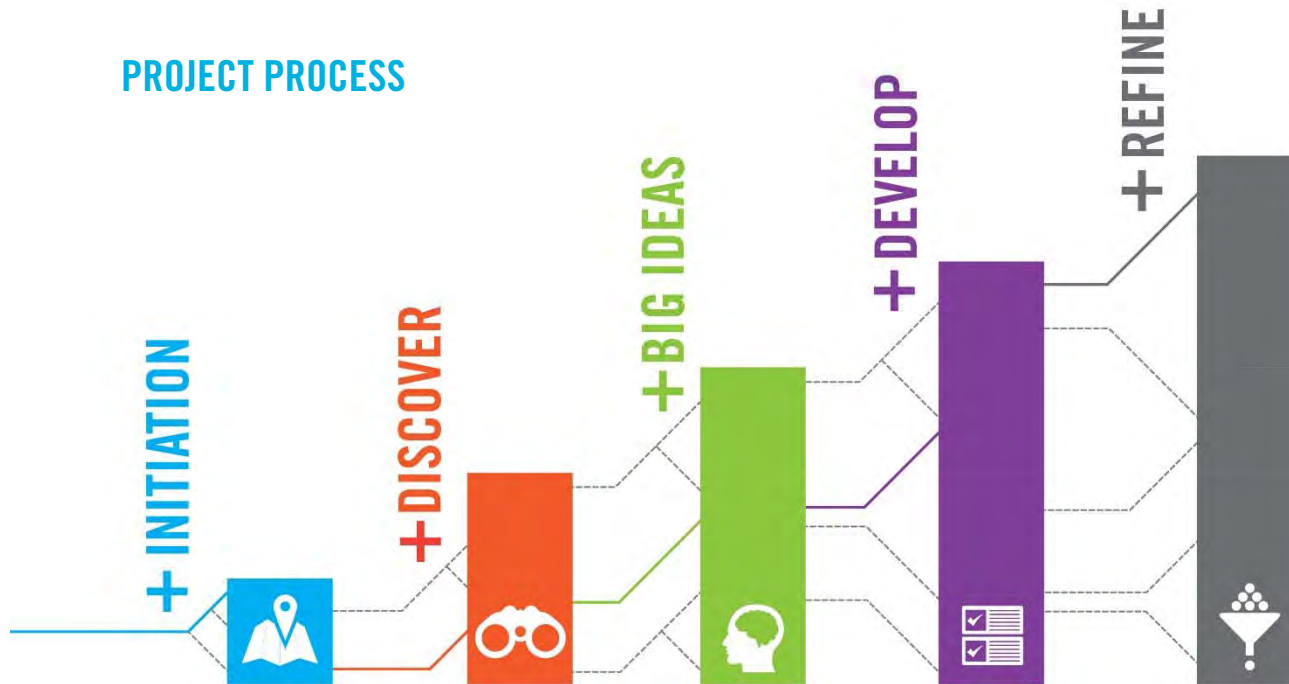

- Finalize space-program and recommendations
- Create implementation plan
- Refine construction cost estimates
- Create list of facilities projects and phasing timeline
- Create draft and final report

# PROJECT SCHEDULE



# FACILITIES CONDITION ASSESSMENT

## FACILITIES CONDITION ASSESSMENT

Building condition and lifespan are key components in long range master plan decision making:

- BUILDING (Name / Date constructed / Area / Renovation)
- SUMMARY DESCRIPTION
- CONSTRUCTION TYPE (Floors, Roof, Walls, Insulation, Envelope, Waterproofing, Interior Panels)
- GENERAL CONDITION / UTILITY
- ELECTRICAL, PLUMBING, AND MECHANICAL SYSTEMS
- CODE / LIFE SAFETY (Stairs and life safety / Automatic sprinkler systems)
- ACCESSIBILITY (ADA Compliance)



# COMMITTEE AND STAKEHOLDER ORGANIZATION

## STAKEHOLDER GROUPS

The A&M System Board of Regents

STEERING COMMITTEE

ADVISORY COMMITTEE / TASK FORCE

Will sign off the final master plan once completed.



**THE TEXAS A&M  
UNIVERSITY SYSTEM**

## STAKEHOLDER GROUPS

The A&M System Board of Regents

STEERING COMMITTEE

ADVISORY COMMITTEE / TASK FORCE

Usually comprised of institutional executive administration, this group is the **lead decision-making body**. The Steering Committee will make decisions on all aspects of the project.



### STATS:

- Number of People 6-10
- Convenes as part of the master planning process workshops (and web-conferences if necessary)
- Typical meeting length 90-120 minutes
- Key Role: Direction on key decision

## STAKEHOLDER GROUPS



The A&M System Board of Regents

STEERING COMMITTEE

ADVISORY COMMITTEE

This group will provide **input and recommendation** on the master plan to the Steering Committee. The Advisory Committee's recommendations will be on functional, operational, programming, aesthetic, and technical aspects of this project. Comprised of university representatives including faculty, staff, students, and community members.

### STATS:

- Number of People 16-20
- Convenes as part of the master plan workshop process
- Typical meeting length 90-120 minutes
- Key Role: Topic based advice and campus insights

## STAKEHOLDER GROUPS



The A&M System Board of Regents

STEERING COMMITTEE

ADVISORY COMMITTEE

USER GROUPS

### Initial User Groups (Symposium 1):

- Student Life
- Athletics
- Academics + Research

### Potential Future User Group Discussions:

- Transportation + Mobility
- Resiliency + Sustainability
- TBD...

## STAKEHOLDER GROUPS



The A&M System Board of Regents

STEERING COMMITTEE

ADVISORY COMMITTEE

USER GROUPS

PUBLIC + COMMUNITY

### Potential External Stakeholders:

- City of Canyon
- City of Amarillo
- Chamber of Commerce
- Canyon ISD
- Foundations



**THIS IS AN UPDATE**



Agricultural Sciences Building (\$38 million 150,000sf)



# FOOTBALL STADIUM

Buffalo Sports Park



### West Texas A&M Enrollment

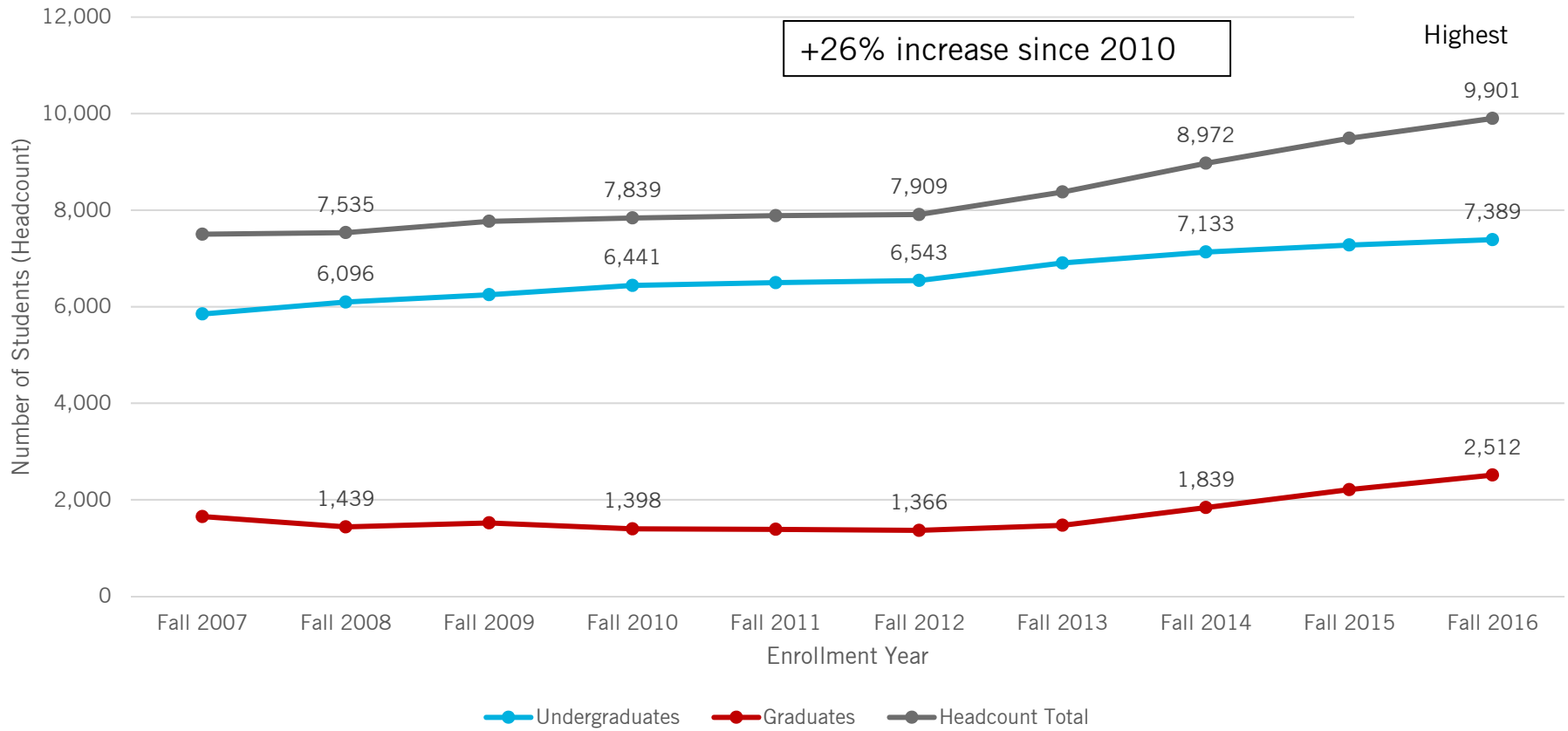

### Enrollment Percent Increase Annually West Texas A&M University

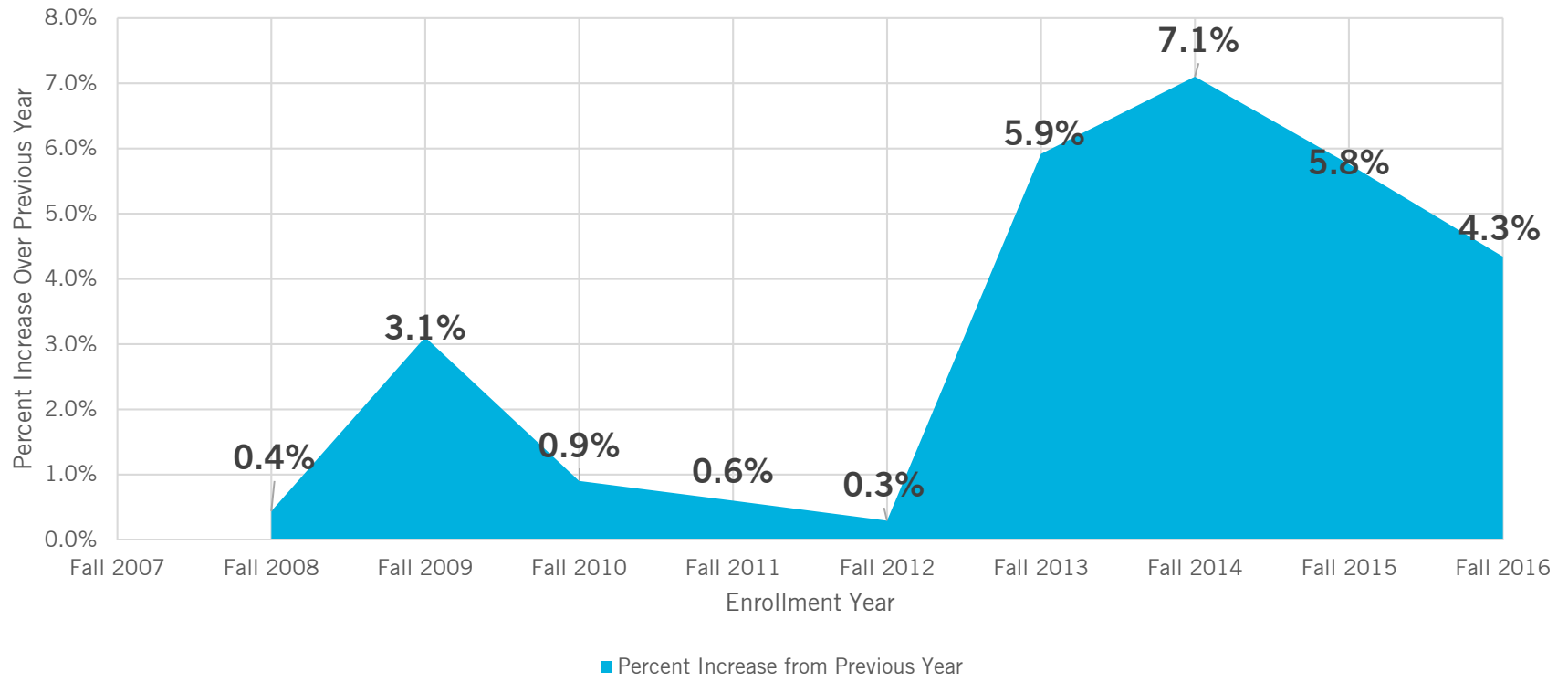

Since previous master  
plan (2010)...

**+26%** net enrollment increase

**+79%** graduate student increase

## 2010 MASTER PLAN ENROLLMENT TARGETS

1. Provide adequate facilities to meet enrollment targets of 8,500, 9,000, 10,000 and 15,000 students

## Headcount to FTE Enrollment West Texas A&M University

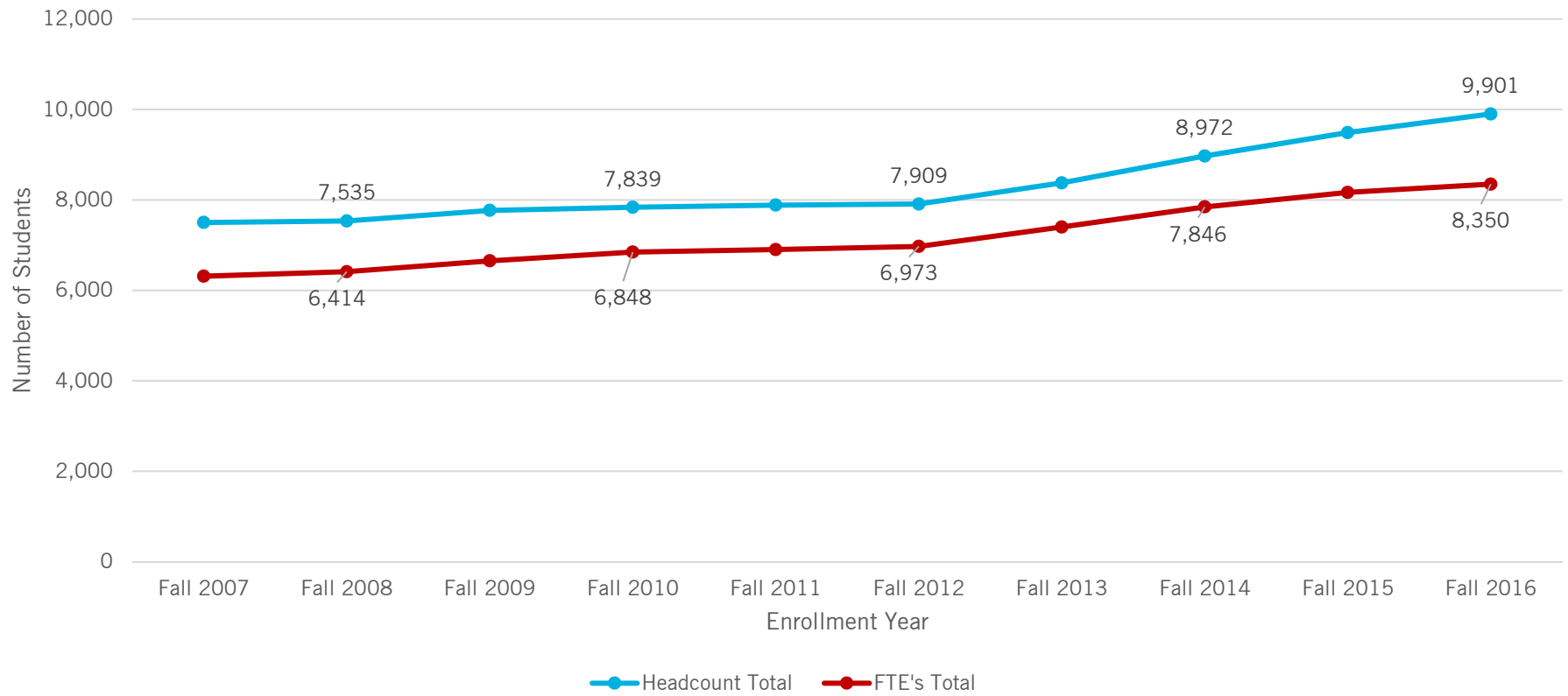

Enrollment Comparison Graduate and Undergraduate

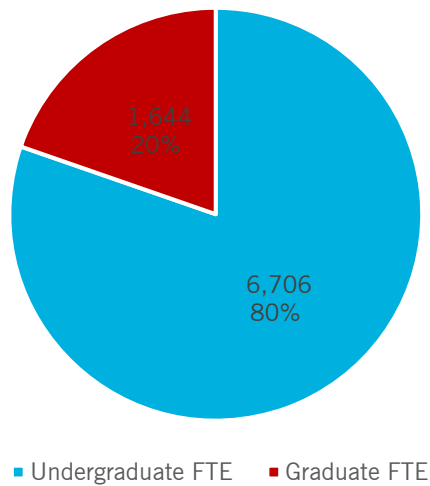

For every 1 graduate student there are 5 undergraduates

0.84 FTE-to-Headcount Ratio

**FTE Enrollment by College**  
West Texas A&M University

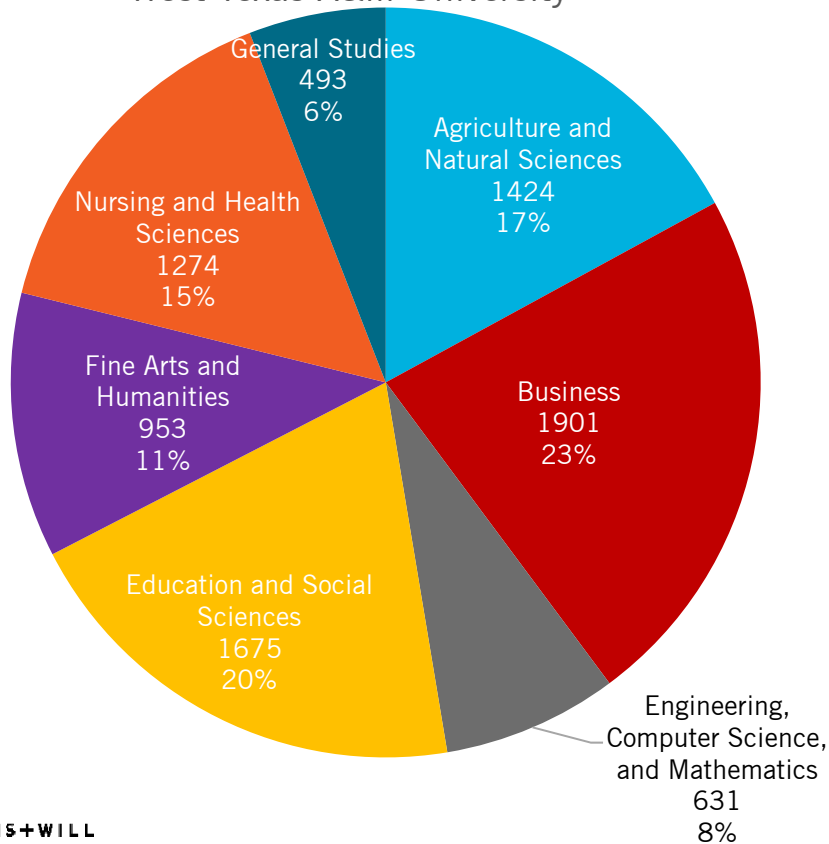

The School of Business is the fastest growing college followed by Engineering, Computer Science, and Mathematics



# 2010 MASTER PLAN

# EXISTING CAMPUS



PERKINS+WILL

PREVIOUS  
MASTER PLAN

SASAKI ASSOCIATES  
2010



PERKINS+WILL

## IMPLEMENTED PROJECTS

### Projects (In Master Plan)

- Jack B. Kelley Student Center Expansion
- Old Main Entry Improvements
- Central Plant Expansion
- Centennial Hall
- Founders Hall
- Bain Athletic Center (partial/ smaller footprint)
- Soccer / Track Stadium
- Buffalo Sports Park Lawn
- North Parking Lot
- ECS Renovation
- Activities Center Renovation
- 23<sup>rd</sup> / University Ave
- Hudspeth Hall Demolition
- Old Fine Arts Building Demo

### (Not in Master Plan)

- Agriculture Complex

PERKINS+WILL



## PROJECTS NOT IMPLEMENTED

In Master Plan , Not Completed

- Several new / replacement residence halls (4/6?)
- Cornette Library Expansion
- Old Education Renovation
- Palo Duro Research Expansion / New Building
- Academic Expansion
- Alumni Banquet Expansion
- Stafford Hall Demolition
- Old Student Union Demolition
- Student Enrichment Center (near First United Bank Center)
- Parking at Russell Long
- 24<sup>th</sup> Street & 4<sup>th</sup> Ave Improvements
- “Shelter Belt” / Extensive Tree planting
- 26<sup>th</sup> Street Pedestrian Improvements (partial – closed to traffic)

PERKINS+WILL



# CAMPUS UNDERSTANDING IMMERSION

## REGIONAL CONTEXT & CAMPUS RELATIONSHIPS

### MAIN CAMPUS

- 250 acre Main Campus.
- Home of the Buffaloes and over 2500 on-campus residents.
- Serves approx. 10k students.
- 58 undergraduate programs
- 39 masters programs
- 1 doctorate program.
- Location of the Panhandle-Plains Historical Museum.

### AMARILLO CENTER

- 15 miles north of the Main Campus located in Downtown Amarillo.
- Offers select upper-level and Graduate courses.
- Serves approx. 420 students
- Moving into a new facility Fall of 2018.
- Houses specialty programs such as the Communication Disorders Program, Speech and Hearing Clinic, and Center for Learning Disabilities.

### NANCE RANCH

- 7 miles east of the Main Campus.
- 2,310 Acre working agriculture, biology and environmental lab
- Testing facility for renewable energy sources, specifically wind turbines.

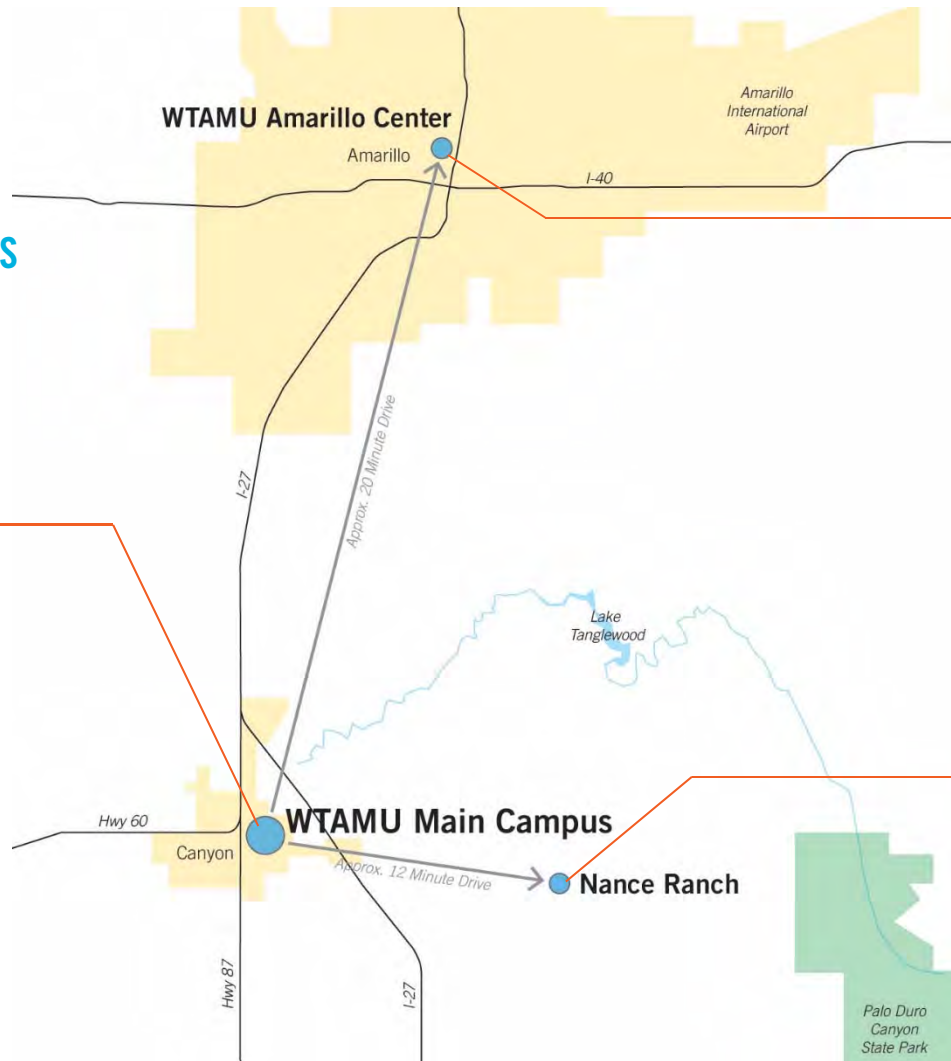

# AMARILLO CENTER



AC1



Current Location  
in Chase Tower

New Location  
Opening Fall 2018

S. Tyler Street

8th Avenue

West Texas A&M Amarillo Center  
Downtown Amarillo, Texas

**Slide 74**

---

**AC1**

Admire, Caitlin, 9/1/2017



S. Tyler Street

8<sup>th</sup> Avenue



# MAIN CAMPUS

## ENVIRONMENTAL CONTEXT

## FLOOD ZONES TOPOGRAPHY

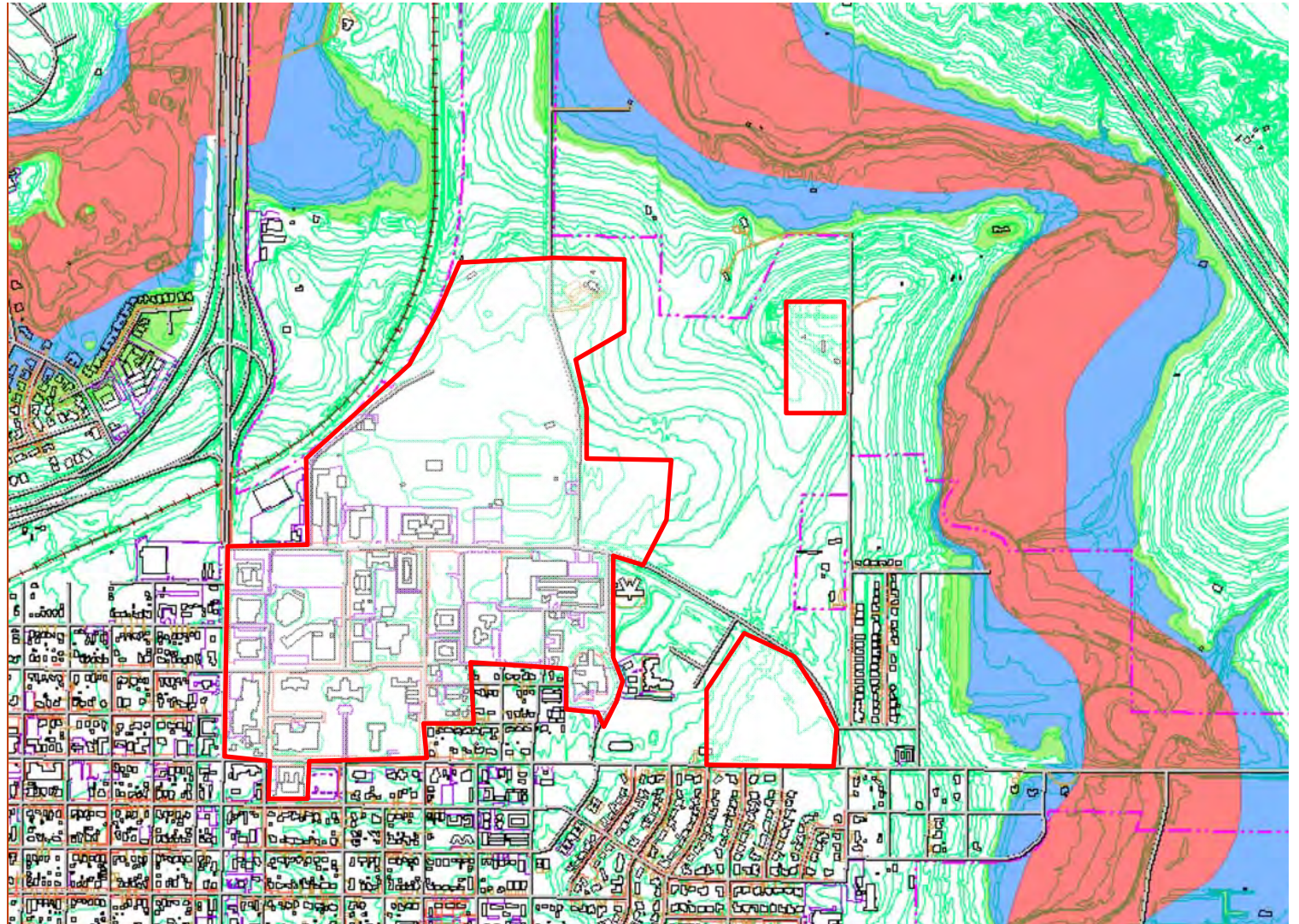

Data: City of Canyon

PERKINS+WILL

## EXISTING BUILDINGS



## EXISTING WALKWAYS

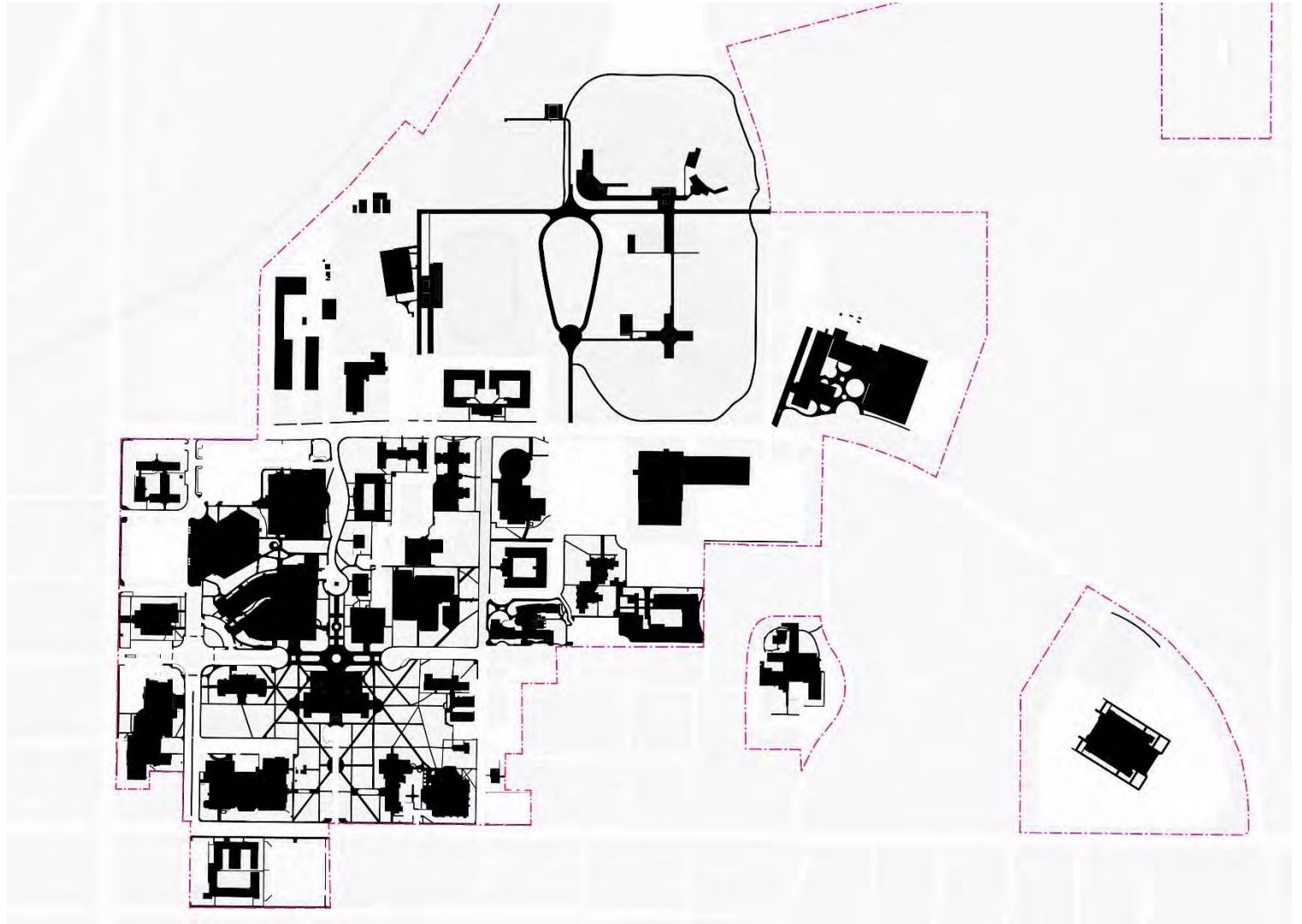



EXISTING STREET  
NETWORK



EXISTING PARKING  
(TOTAL PERVIOUS)

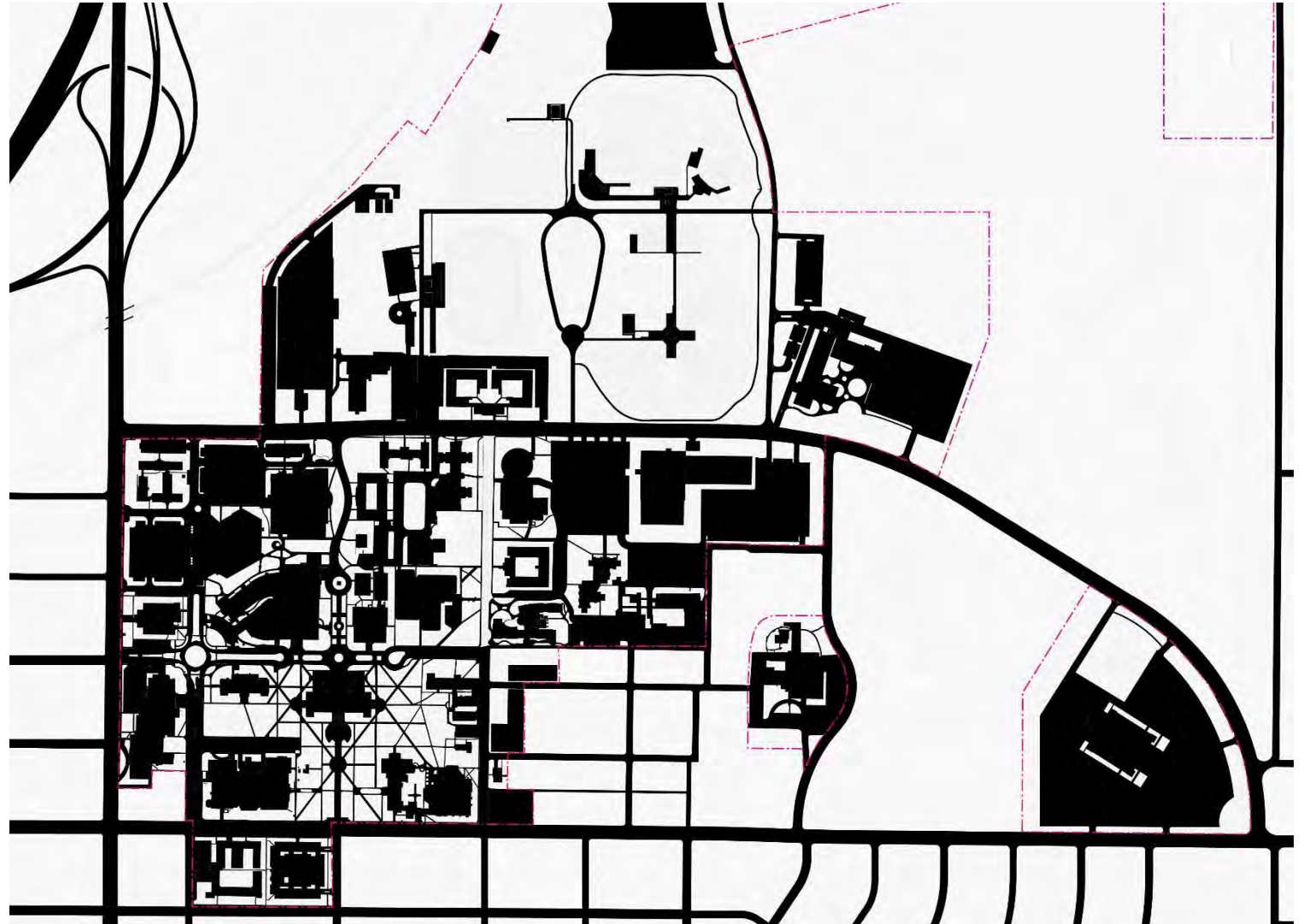

PERKINS+WILL

## BUILDING USES

-  Academics / Research
-  Commons
-  Housing
-  Athletics / Rec
-  Admin / Support
-  Not in use

COMMONS – STUDENT LIFE  
LIBRARY – BLUE  
PLAINS MUSEUM

PERKINS+WILL

